

FLANGED TYPE BFR

INSTALLATION DIMENSIONS

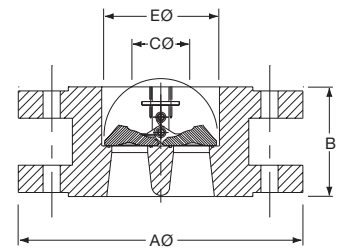
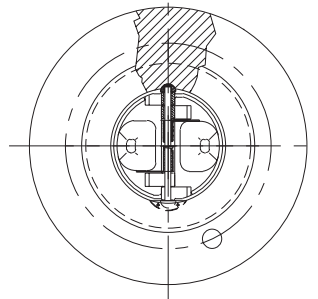

ANSI B16.5 / ANSI B16.47 SERIES A

FLANGE DETAIL

Size inches	Pressure Rating ANSI	End Facing	A Ø mm	B mm	C Ø mm	E Ø mm	HOLE P.C.D. mm	HOLE DIA. mm	STUD SELECTION			Δ VALVE APPROX WEIGHT kg
									No. §	Diameter inches	*Length mm	
8 (200mm)	150	RF	343	127	171	207	298.5	22.2	8	3/4	140	49
10 (250mm)	150	RF	406	146	235	260	362.0	25.4	12	7/8	150	82
	600	RF/RJ-53	508	213	200	260	431.8	34.9	16	1 1/4	245	183
	900	RF/RJ-53	546	241	195	260	469.9	38.1	16	1 3/8	265	203
12 (300mm)	150	RF	483	181	260	300	431.8	25.4	12	7/8	150	125
	300	RF	521	181	260	300	450.8	31.8	16	1 1/8	205	153
	600	RF/RJ-57	559	229	232	300	489.0	34.9	20	1 1/4	255	239
14 (350mm)	900	RF/RJ-57	610	292	206	300	533.4	38.1	20	1 3/8	285	347
	150	RF	533	184	286	339	476.3	28.6	12	1	165	144
	300	RF	584	222	286	339	514.4	31.8	20	1 1/8	210	207
16 (400mm)	600	RF/RJ-61	603	273	232	339	527.0	38.1	20	1 3/8	265	378
	900	RF/RJ-62	641	356	0	339	558.8	41.3	20	1 1/2	310	470
	150	RF	597	191	332	387	539.8	28.6	16	1	170	176
18 (450mm)	300	RF	648	232	305	387	571.5	34.9	20	1 1/4	220	301
	600	RF/RJ-65	686	305	330	387	603.2	41.3	20	1 1/2	285	451
	900	RF/RJ-66	705	384	162	387	616.0	44.5	20	1 5/8	325	610
20 (500mm)	150	RF	635	203	395	438	577.9	31.8	16	1 1/8	180	210
	300	RF	711	264	391	438	628.6	34.9	24	1 1/4	230	392
	600	RF/RJ-69	743	362	330	438	654.0	44.5	20	1 5/8	305	560
24 (600mm)	900	RF/RJ-70	787	451	244	438	685.8	50.8	20	1 7/8	365	843
	150	RF	699	219	438	487	635.0	31.8	20	1 1/8	190	270
	300	RF	775	292	438	487	685.8	34.9	24	1 1/4	240	489
26 (650mm)	600	RF/RJ-73	813	368	432	487	723.9	44.5	24	1 5/8	325	762
	900	RF/RJ-74	857	451	406	487	749.3	54.0	20	2	385	1782
	150	RF	813	222	537	579	749.3	35.0	20	1 1/4	205	409
28 (700mm)	300	RF	914	318	524	579	812.8	41.3	24	1 1/2	265	756
	600	RF/RJ-77	940	438	510	579	838.2	50.8	24	1 7/8	365	1143
	900	RF/RJ-78	1041	495	445	579	901.7	66.7	20	2 1/2	485	1750
30 (750mm)	150	RF	870	356	597	629	806.5	34.9	24	1 1/4	245	1007
	300	RF	972	356	597	629	876.3	44.5	28	1 5/8	290	1238
	600	RF/RJ-93	1016	457	578	629	914.4	50.8	28	1 7/8	390	1418
32 (800mm)	900	RF/RJ-100	1086	533	559	629	952.5	73.0	20	2 3/4	510	1991
	150	RF	927	381	648	680	863.6	35.0	28	1 1/4	255	1025
	300	RF	1035	381	648	680	939.8	44.5	28	1 5/8	305	1120
30 (750mm)	600	RF/RJ-93	1073	483	629	680	965.2	54.0	28	2	405	1467
	900	RF/RJ-100	1168	572	610	680	1022.4	79.4	20	3	525	2426
	150	RF	984	305	641	735	914.4	35.0	28	1 1/4	260	793
30 (750mm)	300	RF	1092	368	641	735	997.0	47.6	28	1 3/4	325	1283
	600	RF/RJ-95	1130	505	584	735	1022.4	54.0	28	2	410	1575
	900	RF/RJ-102	1232	635	584	735	1085.9	79.4	20	3	540	3829
32 (800mm)	150	RF	1060	356	641	784	977.9	41.3	28	1 1/2	290	950
	300	RF	1149	406	641	784	1054.1	50.8	28	1 7/8	345	1354
	600	RF/RJ-96	1194	533	610	784	1079.5	60.3	28	2 1/4	430	1977
900	RF/RJ-103	1314	660	610	784	1155.7	60.3	20	3 1/4	570	3425	

* Where Ring Joint Facing shown in End Facing, Stud lengths based on Ring Joint flange connection.

Δ Weights are for valve only and exclude mating flanges and bolting. Weight will vary according to corrosion allowance specification.

§ Number of studs is per flange, therefore, double the amount for valve installation purposes

VALVE SIZE	2" to 24"	26" to 60"	66" to 144"
FLANGE STANDARD	ANSI B16.5	ANSI B16.47 SERIES A (MSS SP44)	AWWA C207 (CLASS E 275 PSI)

FLANGED TYPE BFR

INSTALLATION DIMENSIONS

ANSI B16.47 SERIES A / AWWA C207 CLASS E

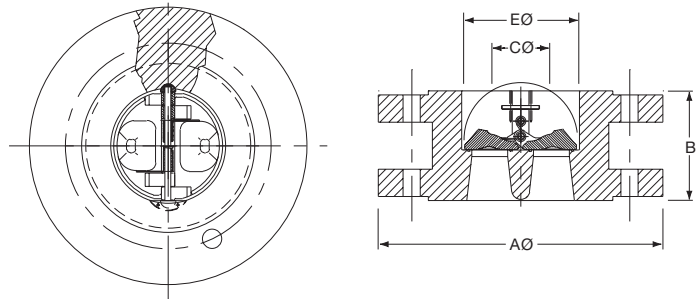

Size inches	Pressure Rating ANSI	End Facing	A Ø mm	B mm	C Ø mm	E Ø mm	HOLE P.C.D mm	HOLE DIA. mm	FLANGE DETAIL			Δ VALVE APPROX WEIGHT kg
									STUD SELECTION			
									No. §	Diameter inches	Length mm	
36 (900mm)	150	RF	1168	368	648	865	1085.9	41.3	32	1 1/2	305	1148
	300	RF	1270	483	648	865	1168.4	54.0	32	2	360	1993
	600	RF/RJ-98	1314	635	527	865	1193.8	60.3	28	2 1/2	455	2877
	900	RF/RJ-105	1461	718	356	865	1289.1	92.1	20	3 1/2	615	**
40 (1000mm)	150	RF	1289	432	883	987	1200.2	41.3	36	1 1/2	305	1515
	300	RF	1238	546	749	909	1155.7	44.5	32	1 5/8	360	3073
	600	RF	1321	660	743	909	1212.9	60.3	32	2 1/4	490	6314
	900	RF	1511	762	737	909	1339.9	92.1	24	3 1/2	630	6688
42 (1050mm)	150	RF	1346	432	935	1062	1257.3	41.3	36	1 1/2	320	2170
	300	RF	1289	568	837	1015	1206.5	44.5	32	1 5/8	370	4429
	600	RF	1403	702	648	972	1282.7	66.7	28	2 1/2	520	5278
	900	RF	1562	787	584	972	1390.7	92.1	24	3 1/2	650	**
48 (1200mm)	150	RF	1511	524	1037	1193	1422.4	41.3	44	1 1/2	340	2750
	300	RF	1467	629	965	1136	1371.6	50.8	32	1 7/8	410	5010
	600	RF	1594	787	889	1136	1460.5	73.0	32	2 3/4	575	5043
54 (1350mm)	150	RF	1683	591	1092	1281	1593.9	47.6	44	1 3/4	380	3267
	300	RF	1657	718	1092	1281	1549.4	60.3	28	2 1/4	470	**
60 (1500mm)	150	RF	1854	660	1207	1422	1759.0	47.6	52	1 3/4	400	**
	300	RF	1810	838	1207	1422	1701.8	60.3	32	2 1/4	490	**
66 (1650mm)	150	RF	2032	787	1435	1663	1930.4	47.6	52	1 3/4	300	7000
72 (1800mm)	150	RF	2197	851	1530	1818	2095.5	47.6	60	1 3/4	305	**
78 (1950mm)	150	RF	2362	927	1664	1974	2260.6	54.0	64	2	340	**
84 (2100mm)	150	RF	2534	1041	1753	2116	2425.7	54.0	64	2	340	**
90 - 144 (2250mm- 3600mm)	150	RF	**	**	**	**	**	**	**	**	**	**

* Where Ring Joint Facing shown in End Facing, Stud lengths based on Ring Joint flange connection.

Δ Weights are for valve only and exclude mating flanges and bolting. Weight will vary according to corrosion allowance specification.

§ Number of studs is per flange, therefore, double the amount for valve installation purposes

** Apply to Goodwin for details.

VALVE SIZE	2" to 24"	26" to 60"	66" to 144"
FLANGE STANDARD	ANSI B16.5	ANSI B16.47 SERIES A (MSS SP44)	***AWWA C207 (CLASS E 275 PSI)

***Valves 66" to 144" can be supplied with dimensions to suit flange standards AWWA C207 Classes B, D or F and Taylor Forge.

Valve 2", 3", 4", 6" cannot be supplied in Flanged Type due to insufficient space for the two nuts between the flanges whilst complying with API 594 face-to-face dimension. These valves would be supplied as Solid Lug unless otherwise specified by the customer. If flanged type is required in these sizes the valves have extended face-to-face as detailed in the below table. Higher pressure classes are available on request.

FLANGED TYPE BFR (Small Diameter - Extended Body - Non API 594)

ANSI B16.5

Size inches	Pressure Rating ANSI	End Facing	A Ø mm	B mm	C Ø mm	E Ø mm	HOLE P.C.D mm	HOLE DIA. mm	FLANGE DETAIL			Δ VALVE APPROX WEIGHT kg
									STUD SELECTION			
									No. §	Diameter inches	Length mm	
2 (50mm)	150	RF	152	114	0	57	120.7	19.1	4	5/8	105	7
	300	RF	165	114	0	57	127.0	19.1	8	5/8	110	9
3 (80mm)	150	RF	191	133	51	87	152.4	19.1	4	5/8	110	11
	300	RF	210	133	51	87	168.3	22.2	8	3/4	130	15
4 (100mm)	150	RF	229	121	89	113	190.5	19.1	8	5/8	110	16
	300	RF	254	121	89	113	200.0	22.2	8	3/4	135	18
6 (150mm)	150	RF	279	130	140	166	241.3	22.2	8	3/4	120	21
	300	RF	318	130	140	166	269.9	22.2	12	3/4	145	27
8 (200mm)	300	RF	381	152	171	207	330.2	25.4	12	7/8	160	48
10 (250mm)	300	RF	445	178	235	260	387.4	28.6	16	1	175	68