

FLANGED TYPE BFR

INSTALLATION DIMENSIONS

ANSI B16.47 SERIES B

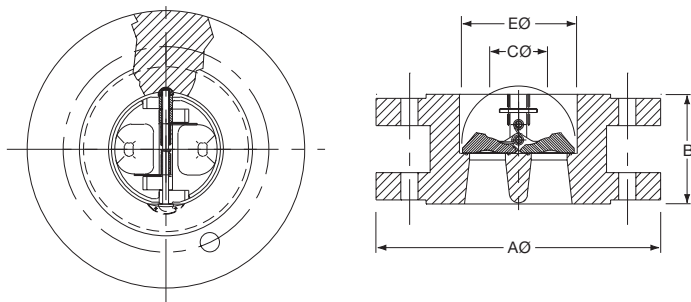

FLANGE DETAIL

Size inches	Pressure Rating ANSI	End Facing	A Ø mm	B mm	C Ø mm	E Ø mm	HOLE P.C.D. mm	HOLE DIA. mm	STUD SELECTION			Δ VALVE APPROX WEIGHT kg
									No. §	Diameter inches	*Length mm	
26 (650mm)	150	RF	786	356	597	629	744.5	22.2	36	3/4	165	906
	300	RF	867	356	597	629	803.3	34.9	32	1 1/4	290	1114
	600	RF/RJ-93	889	457	578	629	806.5	44.5	28	1 5/8	380	1276
	900	RF/RJ-100	1022	533	559	629	901.7	66.7	20	2 1/2	480	1792
28 (700mm)	150	RF	837	381	648	680	795.3	22.2	40	3/4	175	923
	300	RF	921	381	648	680	857.3	34.9	36	1 1/4	290	1008
	600	RF/RJ-94	953	483	629	680	863.6	47.6	28	1 3/4	395	1320
	900	RF/RJ-101	1105	572	610	680	971.6	73.0	20	2 3/4	515	2183
30 (750mm)	150	RF	887	305	641	735	846.1	22.2	44	3/4	175	714
	300	RF	991	368	641	735	920.8	38.1	36	1 3/8	305	1155
	600	RF/RJ-95	1022	505	584	735	927.1	50.8	28	1 7/8	420	1418
	900	RF/RJ-102	1181	635	584	735	1035.1	79.4	20	3	545	3446
32 (800mm)	150	RF	941	356	641	784	900.2	22.2	48	3/4	175	855
	300	RF	1054	406	641	784	977.9	41.3	32	1 1/2	330	**
	600	RF/RJ-96	1086	533	610	784	984.3	54.0	28	2	440	2642
	900	RF/RJ-103	1238	660	610	784	1092.2	79.4	20	3	555	2642
36 (900mm)	150	RF	1057	368	648	865	1009.7	25.4	44	7/8	195	1033
	300	RF	1172	483	648	865	1089.2	44.5	32	1 5/8	340	1794
	600	RF/RJ-98	1213	635	527	865	1104.9	60.3	28	2 1/4	480	2589
	900	RF/RJ-105	1346	718	356	865	1200.2	79.4	24	3	585	**
40 (1000mm)	150	RF	1175	432	883	987	1120.6	28.6	44	1	210	1364
	300	RF	1273	546	749	909	1190.6	44.5	40	1 5/8	365	3380
42 (1050mm)	150	RF	1226	432	935	1062	1171.4	28.6	48	1	215	1953
	300	RF	1334	568	837	1015	1244.6	47.6	36	1 3/4	375	4872
48 (1200mm)	150	RF	1392	524	1037	1193	1335.0	31.8	44	1 1/8	235	2475
	300	RF	1511	629	965	1136	1416.1	50.8	40	1 7/8	400	5511
54 (1350mm)	150	RF	1549	591	1092	1281	1492.3	31.8	56	1 1/8	245	2940
	300	RF	1673	718	1092	1281	1577.8	50.8	48	1 7/8	415	**
60 (1500mm)	150	RF	1726	660	1207	1422	1662.2	34.9	52	1 1/4	260	**
	300	RF	1878	838	1207	1422	1763.8	60.3	40	2 1/4	465	**

Δ Weights are for valve only and exclude mating flanges and bolting. Weight will vary according to corrosion allowance specification.

* Where Ring Joint Facing shown in End Facing, Stud lengths based on Ring Joint flange connection.

§ Number of studs is per Flange, therefore double the amount for valve installation requirements

** Apply to Goodwin for details

INTERMEDIATE SIZES ARE AVAILABLE TO SPECIAL ORDER
FACE TO FACE DIMENSIONS ARE TO API 594