

# BUTTWELD END TYPE BWR

## INSTALLATION DIMENSIONS

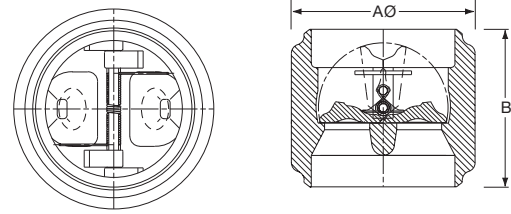

| Size<br>inches | Pressure<br>Rating | A Ø<br>mm | B<br>mm | Δ APPROX<br>WEIGHT<br>kg |
|----------------|--------------------|-----------|---------|--------------------------|
| 3<br>(80mm)    | 150                | 98.0      | 136.0   | 6.5                      |
|                | 300                | 98.0      | 136.0   | 6.5                      |
| 4<br>(100mm)   | 150                | 129.5     | 120.7   | 6.9                      |
|                | 300                | 129.5     | 120.7   | 7.4                      |
|                | 600                | 135.6     | 120.7   | 8.5                      |
|                | 900                | 146.7     | 165.1   | 14                       |
|                | 1500               | 155.1     | 165.1   | 16                       |
| 6<br>(150mm)   | 2500               | 169.8     | 165.1   | 19                       |
|                | 150                | 168.3     | 136.5   | 13                       |
|                | 300                | 168.3     | 136.5   | 13                       |
|                | 600                | 171.9     | 136.5   | 15                       |
| 8<br>(200mm)   | 900                | 228.8     | 206.4   | 28                       |
|                | 1500               | 228.8     | 206.4   | 37                       |
|                | 2500               | 228.8     | 206.4   | 44                       |
|                | 150                | 226.5     | 152.4   | 22                       |
| 10<br>(250mm)  | 300                | 226.5     | 152.4   | 25                       |
|                | 600                | 239.5     | 215.9   | 43                       |
|                | 900                | 252.2     | 292.1   | 69                       |
|                | 1500               | 284.2     | 292.1   | 92                       |
|                | 2500               | 312.6     | 292.1   | 113                      |
| 12<br>(300mm)  | 150                | 270.6     | 187.3   | 43                       |
|                | 300                | 270.6     | 187.3   | 43                       |
|                | 600                | 289.4     | 262.0   | 78                       |
|                | 900                | 305.7     | 262.0   | 90                       |
|                | 1500               | 346.5     | 346.1   | 159                      |
| 14<br>(350mm)  | 2500               | 367.3     | 346.1   | 179                      |
|                | 150                | 329.5     | 215.9   | 63                       |
|                | 300                | 329.5     | 215.9   | 69                       |
|                | 600                | 351.8     | 292.1   | 117                      |
|                | 900                | 372.6     | 317.5   | 159                      |
| 16<br>(400mm)  | 1500               | 419.2     | 349.3   | 234                      |
|                | 2500               | 367.3     | 412.8   | 344                      |
|                | 150                | 380.0     | 260.4   | 102                      |
|                | 300                | 380.0     | 260.4   | 113                      |
|                | 600                | 381.8     | 355.6   | 199                      |
| 18<br>(450mm)  | 900                | 381.8     | 355.6   | 231                      |
|                | 1500               | 429.6     | 355.6   | 264                      |
|                | 150                | 425.3     | 304.8   | 146                      |
|                | 300                | 425.3     | 304.8   | 164                      |
|                | 600                | 441.0     | 400.1   | 263                      |
| 20<br>(500mm)  | 900                | 469.5     | 400.1   | 315                      |
|                | 1500               | 493.8     | 438.2   | 434                      |

| Size<br>inches | Pressure<br>Rating | A Ø<br>mm | B<br>mm | Δ APPROX<br>WEIGHT<br>kg |
|----------------|--------------------|-----------|---------|--------------------------|
| 18<br>(450mm)  | 150                | 475.4     | 330.2   | 190                      |
|                | 300                | 475.4     | 330.2   | 215                      |
|                | 600                | 487.5     | 409.6   | 306                      |
|                | 900                | 519.5     | 447.7   | 423                      |
| 20<br>(500mm)  | 1500               | 555.4     | 457.2   | 568                      |
|                | 150                | 526.7     | 400.1   | 273                      |
|                | 300                | 526.7     | 400.1   | 213                      |
|                | 600                | 539.9     | 495.3   | 461                      |
| 24<br>(600mm)  | 900                | 578.0     | 546.1   | 637                      |
|                | 1500               | 621.7     | 546.1   | 855                      |
|                | 150                | 609.6     | 342.9   | 361                      |
|                | 300                | 609.6     | 419.1   | 458                      |
| 28<br>(700mm)  | 600                | 635.4     | 546.1   | 722                      |
|                | 900                | 680.1     | 603.2   | 1020                     |
|                | 1500               | 738.5     | 660.4   | 1401                     |
|                | 150                | 711.2     | 374.7   | 435                      |
| 30<br>(750mm)  | 300                | 727.1     | 419.1   | 572                      |
|                | 600                | 774.3     | 489.0   | 910                      |
|                | 900                | 822.1     | 584.2   | 1307                     |
|                | 150                | 762.0     | 387.4   | 596                      |
| 32<br>(800mm)  | 300                | 768.4     | 431.8   | 715                      |
|                | 600                | 819.2     | 508.0   | 1098                     |
|                | 900                | 868.9     | 609.6   | 1568                     |
| 36<br>(900mm)  | 150                | 812.8     | 368.3   | 572                      |
|                | 300                | 833.0     | 431.8   | 792                      |
|                | 600                | 887.3     | 533.4   | 1342                     |
|                | 900                | 940.2     | 635.0   | 1892                     |
| 40<br>(1000mm) | 150                | 914.4     | 419.1   | 921                      |
|                | 300                | 914.4     | 482.6   | 1118                     |
|                | 600                | 944.8     | 552.5   | 1618                     |
|                | 900                | 1003.2    | 660.4   | 2292                     |
| 42<br>(1050mm) | 150                | 1016.0    | 469.9   | 1255                     |
|                | 300                | 1016.0    | 571.5   | 1607                     |
|                | 600                | 1057.8    | 660.4   | 2396                     |
| 48<br>(1200mm) | 900                | 1121.8    | 736.6   | 3256                     |
|                | 150                | 1066.8    | 508.0   | 1637                     |
|                | 300                | 1066.8    | 596.9   | 2013                     |
|                | 600                | 1109.6    | 673.1   | 2739                     |
| 1500           | 900                | 1175.6    | 749.0   | 3767                     |
|                | 150                | 1219.2    | 520.7   | 1922                     |
|                | 300                | 1219.2    | 622.3   | 3180                     |
| 600            | 600                | 1219.2    | 698.5   | 3719                     |
|                | 900                | 1226.6    | 775.0   | 4174                     |

Δ Weights are for valve only and exclude pup or transition pieces. Weight will vary according to corrosion allowance specification.

### PIPE SCHEDULE

Customer must state pipe schedule at time of enquiry as this may necessitate transition prices. The nominal bore of the valve will be determined by the pipe schedule selected by the customer and be in accordance with ASME/ANSI B16.25